

# LEE BROOM

## ORION

### CONTENTS

---

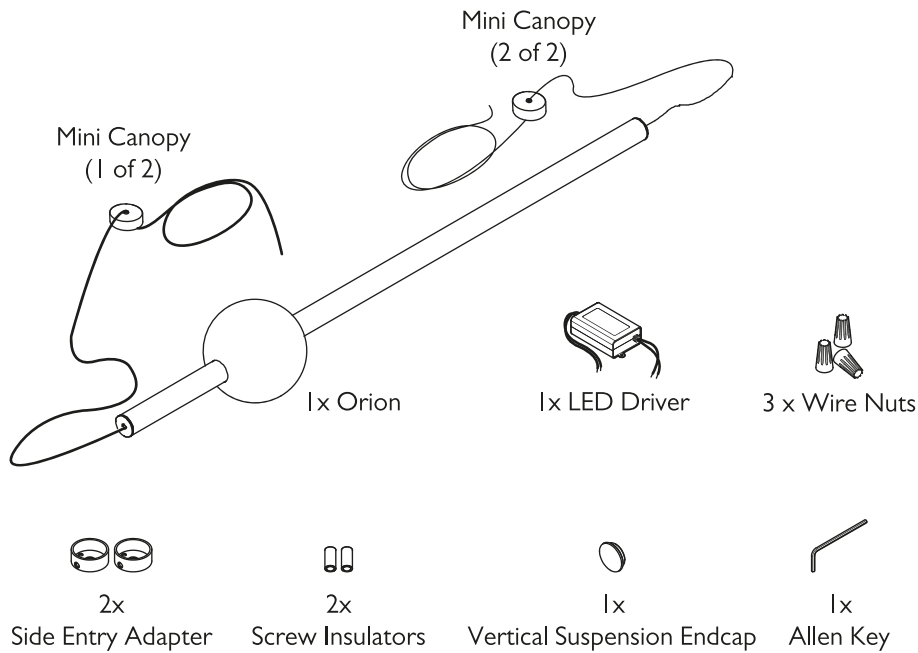

### TECHNICAL

---

ORION GLOBE (ORI0010 / ORI0110)  
INPUT DC 24V; 7.2W

ORION TUBE (ORI0020 / ORI0120)  
INPUT DC 24V; 16.8W

Use only with Class 2 power unit



For more information, please contact:

---

US & Canada Inquiries: +1 212 804 8477 - [sales@leebroom.com](mailto:sales@leebroom.com)

UK & Global Inquiries: +44 207 820 0742 - [info@leebroom.com](mailto:info@leebroom.com)

### CARE AND CLEANING

---

- Only clean when Orion is switched off.
- Please allow a suitable cooling period before cleaning.
- Only use a non-abrasive, soft, dry cloth when cleaning Orion.

## ATTENTION! BEFORE YOU START

---

FOR SAFETY PLEASE READ THESE INSTRUCTIONS CAREFULLY BEFORE YOU COMMENCE INSTALL AND RETAIN THEM FOR FUTURE REFERENCE.

---

- Orion must be installed by a qualified electrician.
- Do not attempt installation unless you are competent.
- Ensure mains power supply is disconnected prior to installation.
- This product is for interior use only and should be installed in a dry environment.
- Handle with care. To avoid fingerprints, wear cotton gloves or use a soft cloth when handling all parts at all times. Clean fingerprints using a soft dry cloth.
- Orion can be suspended either horizontally or vertically. Orion is supplied ready for horizontal suspension.
- To convert Orion to vertical suspension, see Section **B** of these instructions.
- **IMPORTANT!** Product requires 24V DC supply - LED driver **MUST** be used. For latest recommended LED drivers please see:  
[www.leebroom.com](http://www.leebroom.com) > Lighting > Orion



DISCONNECT ALL MAINS POWER SUPPLY WIRES BEFORE INSTALLATION.

---

LED DRIVER MUST BE USED WITH ORION.

---

LOW VOLTAGE LUMINAIRE, DO NOT WIRE THIS PRODUCT DIRECTLY TO AC MAINS POWER SUPPLY.

---

USE ONLY WITH CLASS 2 POWER UNIT.

---

ENSURE ADEQUATE VENTILATION TO LED DRIVER ( $T_a < 50^{\circ}\text{C}$ ).

CHOOSE YOUR INSTALLATION

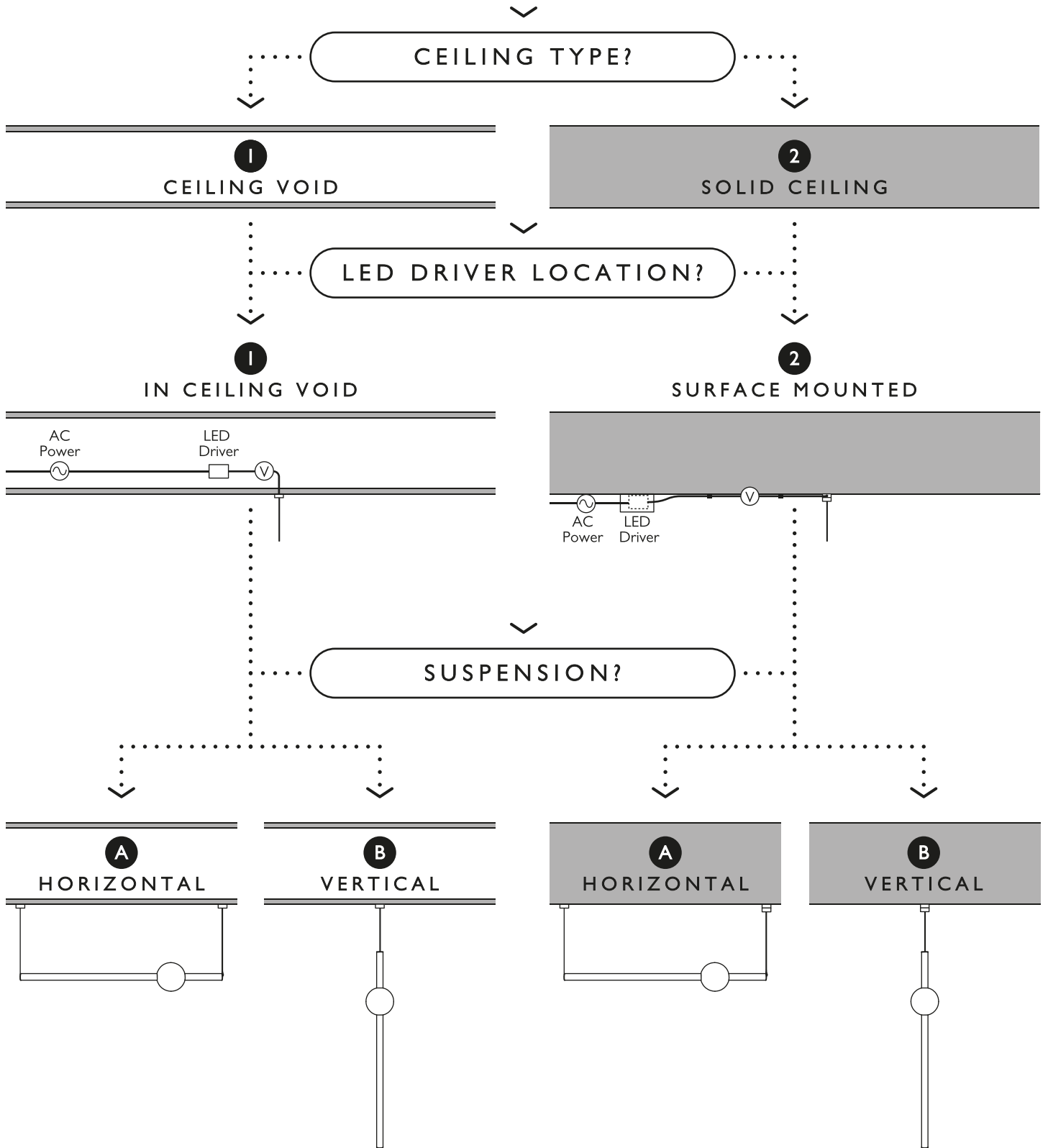

**1** INSTALLATION OPTION 1: LED DRIVER IN CEILING VOID

FOR THIS OPTION:

- Suspended/dropped ceiling.
- Use mini ceiling canopy provided.
- Wired to LED driver located remotely up to 10m (30ft)\* away from luminaire in a suitable enclosure (if required by wiring regulations for your specific region).
- Low voltage wiring running in ceiling void.
- See pages 4-5.

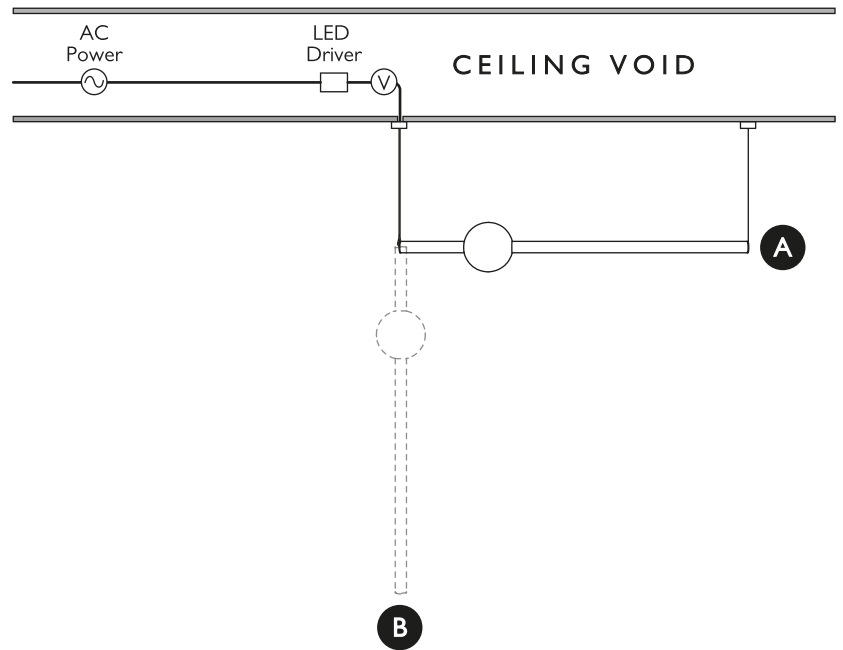

**2** INSTALLATION TYPE 2: LED DRIVER SURFACE MOUNTED

FOR THIS OPTION:

- Solid/concrete ceiling.
- Use supplied mini ceiling canopy plus side entry adapter provided.
- Wired to LED driver located remotely up to 10m (30ft)\* away from luminaire in suitable enclosure. (Follow relevant wiring regulations for your specific region).
- Low voltage wiring running on surface of ceiling or in conduit.
- See pages 6-7.

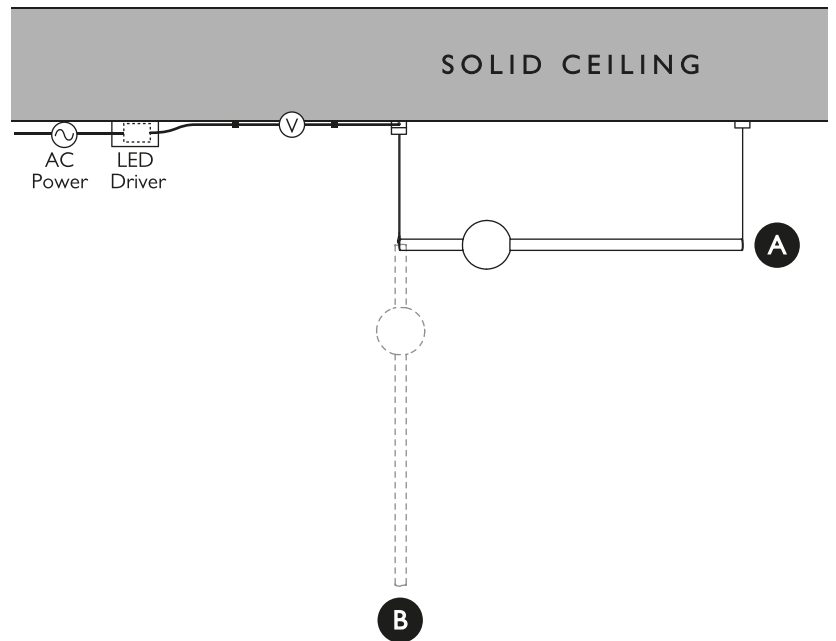

\* this distance can be increased depending on wire gauge used. Consult your electrician.

**I** INSTALLATION OPTION 1: LED DRIVER IN CEILING VOID

**1.1**

Carefully unravel the Orion power cord, taking care not to twist or kink it. Unscrew the canopy cover to separate it from the back plate. Place the side entry adapter to one side.

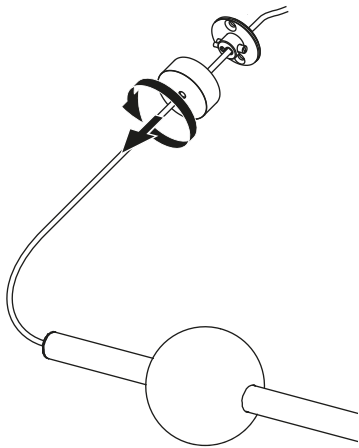

**1.2**

Mark out and drill the fixing holes and cord entry hole as shown. Ensure there is adequate backing and use appropriate fixings to support the luminaire. Fixings not supplied. Find a suitable location for the LED driver in the ceiling and run low voltage cord to the light point.

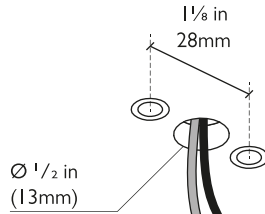

**1.3**

Adjust the drop height as per your requirements by loosening the plastic setscrew on the canopy back plate and pull the cord through. Tie a knot in the cord above the back plate and then retighten the plastic setscrew to secure the cord at desired length.

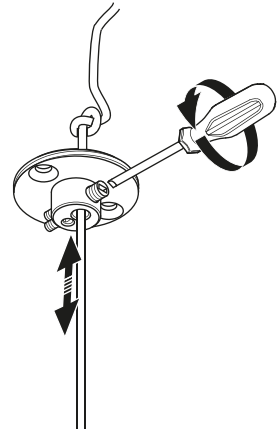

**1.4**

Make electrical connection to the low voltage cord. Wire the Orion to the LED driver DC output, and connect the mains power supply to the LED driver AC input. The LED driver can be located up to 10m (30ft) away from the luminaire. To locate the LED driver further away than this please consult your electrician.

Use suitable power limited circuit cord in ceiling void

make connections

LED driver within suitable ventilated junction box (see below)

**CONNECTION TO LED DRIVER IN REMOTE JUNCTION BOX:  
IMPORTANT! JUNCTION BOX MUST BE WELL VENTILATED**

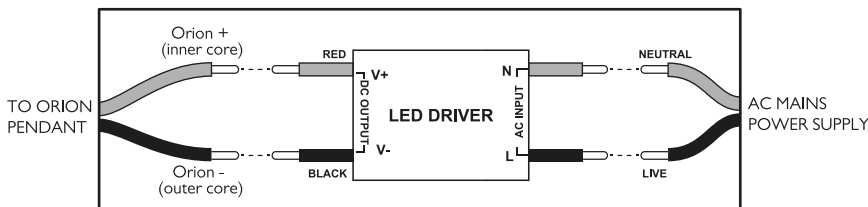

**1.5**

Fix the canopy back plate to the ceiling. It is the client's responsibility to ensure that the fitting is attached to a robust structural substrate with appropriate fixings. Twist the canopy cover onto the back plate.

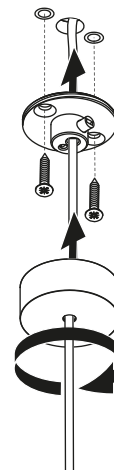

I A

HORIZONTAL SUSPENSION

1.6 (A)

For horizontal suspension, mark out the position of the tensile wire suspension point on the ceiling based on the spacing below.

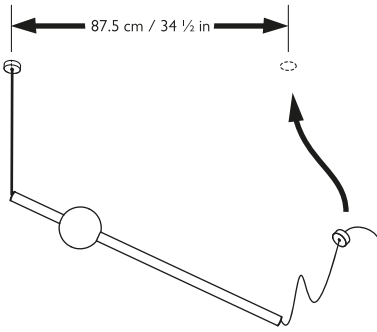

1.7 (A)

Fix the canopy back plate to the ceiling using appropriate fixings for your ceiling type. Adjust the drop equal to the drop at the opposite end, by loosening the two metal setscrews with the allen key and retightening. If necessary drill a centre hole to pass excess tensile wire into your ceiling void - alternatively cut the tensile wire. Finally screw the canopy cover onto the back plate.

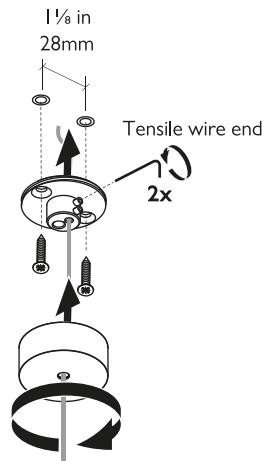

1.8 (A)

Your installation is complete.

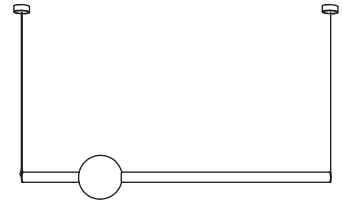

I B

VERTICAL SUSPENSION

1.6 (B)

ORION TUBE:

Unscrew the bottom endcap and remove along with the tensile wire.

ORION GLOBE:

Unscrew and remove bottom endcap then unscrew and remove cord restraint along with the tensile wire.

**IMPORTANT!** Ensure to retain unused spare parts for future reinstallation.

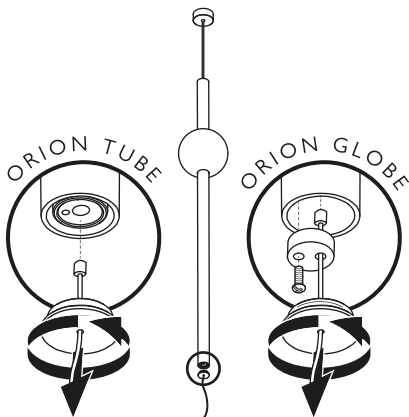

1.7 (B)

Replace the bottom endcap with the spare vertical suspension endcap supplied in the box.

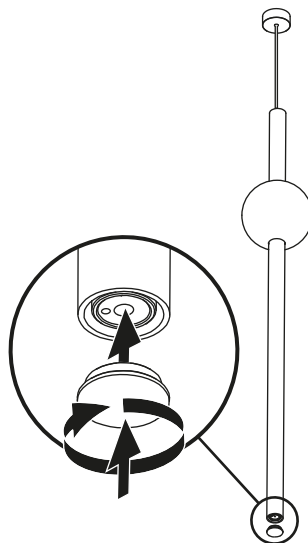

1.8 (B)

Your installation is complete

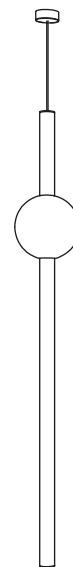

2

INSTALLATION TYPE 2: DRIVER SURFACE MOUNTED

2.1

Carefully unravel the Orion power cord, taking care not to twist or kink it. Unscrew the canopy cover to separate it from the back plate (a). Thread the cord through the side hole in the side entry adapter (b).

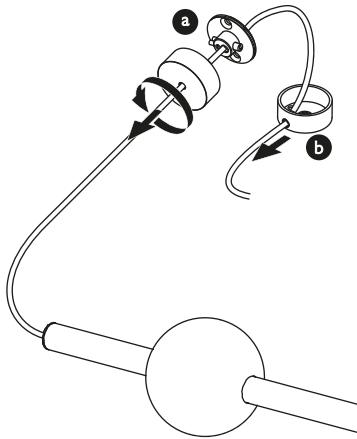

2.2

Mark out and drill the fixing holes as shown. Ensure there is adequate backing and use appropriate fixings to support the luminaire. Fixings not supplied.

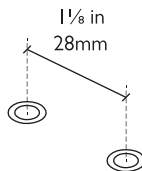

2.3

Adjust the drop height as per your requirements by loosening and retightening the plastic setscrew on the canopy back plate and then pull the cord through the side hole in the side entry adapter. Screw the fitting to the ceiling as shown, passing the screws through the two supplied insulators to protect the cord.

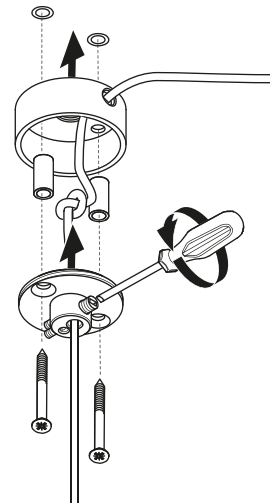

2.4

Wire the Orion to the LED driver DC output, and connect the mains power supply to the LED driver AC input. The driver can be located up to 10m (30ft) away from the luminaire within a suitable enclosure. To locate the driver further away than this please consult your electrician.

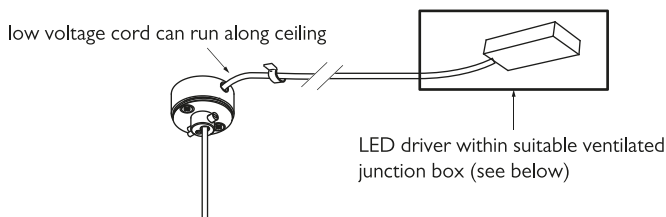

CONNECTION TO LED DRIVER IN REMOTE JUNCTION BOX:  
**IMPORTANT! JUNCTION BOX MUST BE WELL VENTILATED**

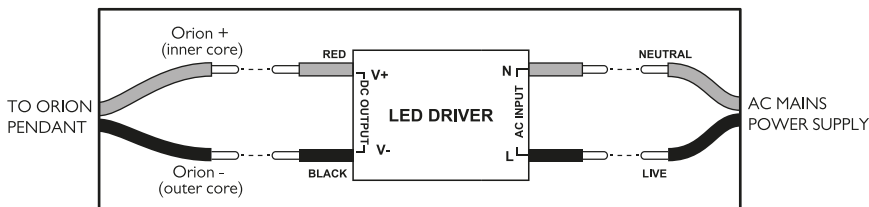

2.5

Twist the canopy cover onto the back plate.

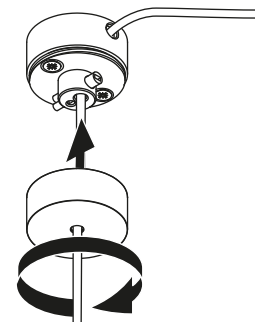

2 A

HORIZONTAL SUSPENSION

2.6 (A)

For horizontal suspension, mark out the position of the tensile wire suspension point on the ceiling based on the spacing below

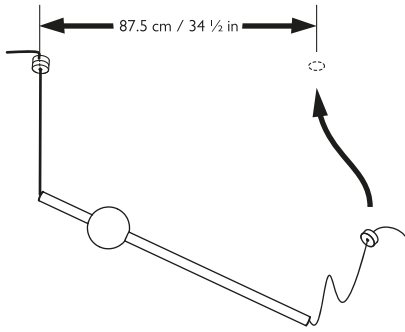

2.7 (A)

Fix the canopy back plate to the ceiling using appropriate fixings for your ceiling type. Adjust the drop equal to the drop at the opposite end, by loosening the two metal setscrews with the allen key and retightening. If necessary drill a centre hole to pass excess tensile wire into your ceiling void - alternatively cut the tensile wire. Finally screw the canopy cover onto the back plate.

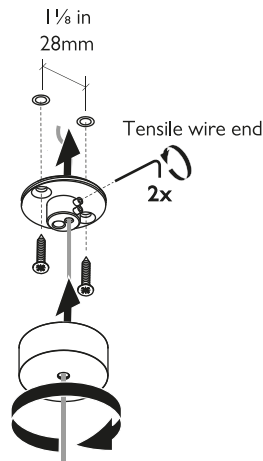

2.8 (A)

Your installation is complete.

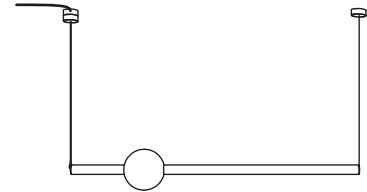

2 B

VERTICAL SUSPENSION

2.6 (B)

ORION TUBE:

Unscrew the bottom endcap and remove along with the tensile wire.

ORION GLOBE:

Unscrew and remove bottom endcap then unscrew and remove cord restraint along with the tensile wire.

**IMPORTANT!** Ensure to retain unused spare parts for future reinstallation.

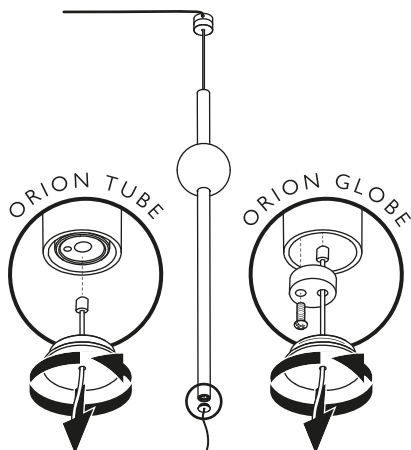

2.7 (B)

Replace the bottom endcap with the spare vertical suspension endcap supplied in the box.

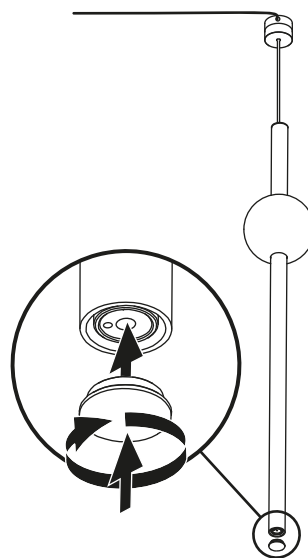

2.8 (B)

Your installation is complete

